

## GENERAL SPECIFICATIONS \*

|  |          |            |
|--|----------|------------|
| • L.O.A  | 18,95m   | 62'2"      |
| • Hull length                                  | 17,60m   | 57'9"      |
| • L.W.L.                                       | 17,00m   | 55'9"      |
| • Beam   | 5,25m    | 17'3"      |
| • Standard draft (L-keel)                      | 2,66m    | 8'9"       |
| • Standard ballast weight (Cast iron)          | 5 010kg  | 11,042 lbs |
| • Shallow draught keel                         | 2,20m    | 7'3"       |
| • Weight of shallow draft keel (Cast iron)     | 5 650kg  | 12,453 lbs |
| • Air draft (excluding antennae)               | 24,44m   | 80'2"      |
| • Performance air draught (excluding antennae) | 26,44m   | 86'9"      |
| • Light displacement                           | 21 700kg | 47,827 lbs |
| • Fuel capacity (standard)                     | 500L     | 132 US Gal |
| • Fresh water capacity (standard)              | 860L     | 227 US Gal |
| • Engine power:                                |          |            |
| - Propeller shaft                              | 150 HP   | 150 HP     |

## ARCHITECTS / DESIGNERS

- Naval Architect: BISCONTINI YACHT DESIGN
- Outside & interior design: LORENZO ARGENTO

## EC CERTIFICATION \*

- Category A - 10 people
- Category B - 14 people
- Category C - 14 people

## STANDARD SAILS DIMENSIONS \*

### ALUMINUM MAST WITH IN-BUILT FURLER

|                         |                      |             |
|-------------------------|----------------------|-------------|
| • Furling mainsail      | 77,00m <sup>2</sup>  | 829 sq/ft   |
| • Self-tacking jib      | 62,00m <sup>2</sup>  | 667 sq/ft   |
| • Furling genoa (105 %) | 75,00m <sup>2</sup>  | 807 sq/ft   |
| • Code 0                | 125,00m <sup>2</sup> | 1,345 sq/ft |
| • Asymmetric spinnaker  | 250,00m <sup>2</sup> | 2,690 sq/ft |
| • I                     | 21,00m               | 68'11"      |
| • J                     | 7,02m                | 23'         |
| • P                     | 20,50m               | 67'3"       |
| • E                     | 7,50m                | 24'7"       |

### PERFORMANCE CLASSICAL MAST, BLACK LACQUERED ALUMINIUM(+ 1,50M / 4'11")

|                                |                      |             |
|--------------------------------|----------------------|-------------|
| • Performance version mainsail | 98,00m <sup>2</sup>  | 1,055 sq/ft |
| • Self-tacking jib             | 78,00m <sup>2</sup>  | 840 sq/ft   |
| • Furling genoa (105 %)        | 85,00m <sup>2</sup>  | 915 sq/ft   |
| • Code 0                       | 140,00m <sup>2</sup> | 1,507 sq/ft |
| • Asymmetric spinnaker         | 270,00m <sup>2</sup> | 2,906 sq/ft |
| • I                            | 22,50m               | 73'10"      |
| • J                            | 7,02m                | 23'         |
| • P                            | 22,00m               | 72'         |
| • E                            | 7,50m                | 24'7"       |

**seanapps**

CONNECT YOUR BOAT **FREE YOUR MIND**

\* Provisional specifications, boat in process of certification.



## STANDARD EQUIPMENT

### CONSTRUCTION

- Design in accordance with European Directive requirements and according to CE certification
- ISO 12215 certified structure
- Monolithic infusion hull
- Structural monolithic infusion counter-mould (fabrics - resin) bonded to the hull
- Fibreglass sandwich, balsa wood, PET foam infusion deck, with diamond pattern non-slip coating
- Cast iron keel attached with bolts and bonded stainless steel backplate
- Twin rudders hung with stainless steel stock
- White coloured hull - Aluminum grey hull decoration
- 6 Hull portholes

### DECK EQUIPMENT

#### RIGGING

- Depending on version:
  - (Aluminium mast with in-fast furling) on cathedral-type deck, 2 Aft swept spreaders - Sparcraft  
Anodised aluminum boom  
Split backstay
  - **Performance black lacquered aluminium classical mast** deck-stepped (+ 1,50m / 4'11"), 3 Aft swept spreaders - Sparcraft  
Black lacquered aluminium canoe boom  
Backstay bridle with 1 built-in Harken manual hydraulic pump operated piston (Hydraulic unit with 2 optional pistons)
- C-strand 1x19 Rigging
- Harken blocks at mast foot
- Rigid boom vang with tackle
- 2 Stand-up blocks for mainsail sheet on mainsail cradle
- 1 Self-tacking jib track with traveller
- All lines brought back to the helm stations (excluding boom uphaul, Genoa halyard and mainsail halyard for version with mast with in-mast furling)
- Complete running rigging:
  - Dyneema mainsail halyard (with tensioning rail on mast for version with in-mast furling)
  - Dyneema Genoa halyard with tensioning rail on mast
  - Boom topping lift with cleat on mast
  - Mainsheet (Dyneema core)
  - 1 Self-tacking jib sheet (Punch)
- Mainsail furler and self-clinching jib furler on deck
- 6 halyard clutches to port (2 doubles and 2 singles)
- 3 clutches to starboard: 1 triple
- Halyard covers
- 2 Flag halyards

#### WINCHES

- 1 Self-tailing electric coach roof winch to port (H50.2 STAEH - 24V)
- 1 Manual self-tailing coach roof winch to starboard (H50.2 STA)
- 1 Aluminum Speed Grip winch handle
- Stowage of which handles in dedicated space in rope bags

#### SAILS (Dacron 480 - Incidence)

##### In-mast roller furler version:

- Dacron furling mainsail with Natural UV protection
- Dacron self-tacking jib with Natural UV protection

##### Performance classical mast version:

- Performance full-batten mainsail, 98 m<sup>2</sup> / 1,055 sq/ft
- Self-tacking jib, 78m<sup>2</sup> / 840 sq/ft
- Charcoal Grey lazy bag + lazy jack

#### MOORING LINES - MOORING

- Polyester bowsprit with integrated anchoring gear and bobstay with spinnaker chainplate (for Code 0 and asymmetric spinnaker)
- Self-draining chain locker, Clench bolt, Piston-driven cover
- Single roller stainless steel bow fitting
- 24 V - 2 000 W vertical electrical windlass - Lewmar - Remote control in mooring locker
- 8 Aluminum mooring cleats (Length: 40 cm / 1'4")
- Stainless steel chafing plate

#### SAIL LOCKER

- Access through T70 deck hatch, Passage width: 0,65 x 0,65m / 2'2" x 2'2"
- Stainless steel ladder
  - Shelving and stowage trays
  - LED lighting
  - 1 230 V socket



## SAFETY ON DECK

- 1 Stainless steel open pulpit
- 2 Stainless steel aft pulpits with integrated fairlead
- 1 Stainless steel aft central pulpit (Height: 960mm / 3'2")
- 4 Stainless steel handrails on coachroof (2 Genoa track)
- 1 Lifebuoy support bracket on aft pulpit
- Wooden flagstaff (1 m/3'3") with integrated support on deck
- Double guard lines and stainless steel stanchions (Height: 620mm / 2') - Side boarding gate on either side
- Emergency ladder on pushpit

## COCKPIT

- Self-draining cockpit
- Teak slatted
- 2 Sail lockers below cockpit seating
- 2 Technical spaces behind the cockpit with stainless steel support for fenders
- 1 Access hatch to tender garage
- 2 Cockpit tables on stainless steel fixed base, teak table top with 2 extension leaves, stainless steel cup holders on the ends with handrail function and 1 long handrail along its full length (electric base in trim)
- Teak slatted cockpit benches
- 2 Aft helmsman's seat with stowage, teak slatted
- Side helm's seats, teak slatted
- Foldaway helmsman foot chock
- 2 Steering wheel consoles:
  - Anthracite leather-clad stainless steel steering wheels (diameter 1 100 mm/3'7") mounted on white polyester pedestal
  - Steering gear at the helm station
  - Stainless steel steering chain transmission system
  - Stainless steel handrail
- 1 Emergency tiller
- 1 Steering compass on port console
- Engine throttle and control panel on starboard
- 1 PPMA folding companionway door in the bottom of the cockpit - Sliding hatch made of PMMA
- Liferaft locker in front of the companionway (Space for 12 place liferaft: 0,96m x 0,59m x 0,40m / 3'2" x 1'11" x 1'4")
- Courtesy lighting (7 LED lighting points, warm white lighting)
- 2 Waterproof exterior speakers (FUSION)

## SWIM PLATFORM / AFT TRANSOM

- Fully opening transom, convertible to bathing platform (2,73m x 1,00m / 8'11" x 3'3")
- 3 Folding access steps to the cockpit to starboard
- Electrically controlled opening on console
- Teak slatted swim deck
- 1 Detachable stainless steel bathing ladder with dedicated stowage in the tender garage

## TENDER GARAGE

- Accessible from the platform and from the cockpit  
For storing a Williams Minijet 280 tender (2,48m x 1,69m x 0,80m / 8'2" x 5'7" x 2'7") - Max. tender length: 2,90m / 9'6" (Highfield classic: 2,90m x 1,70m / 9'6" x 5'7")
- 1 Touch-operated ceiling LEDs
  - Tender launching system, available as an option
  - 1 Cockpit shower with mixer tap in the tender garage
  - Fresh water inlet fed by the tanks for rinsing the tender

## INTERIOR

- Alpi walnut woodwork and white lacquered wood (Partitions)
- Alpikord oak floorings
- Lounge Greige 160 fabric interior upholstery
- Mattresses in the cabins (HR foam 35 kg/m<sup>3</sup>, thickness 120 mm/5")
- Beige padded ceilings and Apli walnut in the central part of the saloon

## Standard version: 3 cabins + 3 heads

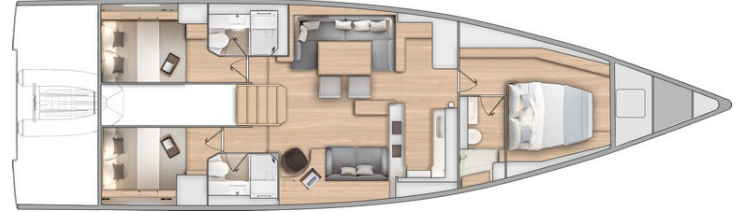

## COMPANIONWAY

Headroom: 2,05m / 6'9"

- Saloon companionway with 5 hanging steps in Alpikord oak, with non-slip coating, LED lighting below each step
- 2 Chocolat DK02 leather sheathed stainless steel handrails
- Opaque film on companionway hatch cover

## SALOON

Headroom: 2,02m / 6'8"

- Chocolat DK02 leather clad stainless steel handrails on ceiling
- 2 T60 flush-fit deck hatches with blind/mosquito nets
- 4 Coach roof windows with pleated blinds including 2 opening portholes with mosquito net
- 2 Long portholes with built-in blind
- Indirect LED lighting on the upper part of the portholes

## Port saloon:

- Long U-shaped bench seat:
  - seats made from HR40 foam
  - soft seating thanks to the memory material trim + padding
- Saloon table, wooden top, 2 fixed aluminum legs
- Storage under bench seats
- 1 Port-side electrical panel incorporated into furniture giving access to the electrical connections
- Indirect LED lighting below the bench seat and the upper part of the portholes
- 2 Flexible reading lights
- 1 dual USB port
- 1 230 V socket

## Starboard saloon:

- 1 Sofa facing the saloon
  - seats with HR26 and HR30 foam,
  - softness thanks to the finish with hollow fibres + padding
- Stowage under the seating
- 1 Central furniture unit with 2 drawers

## Starboard chart table:

- Desk with drop-leaf - glove compartment - stowage - moulded wood fiddle with Chocolat DK02 leather clad stainless steel handrail
- Chocolat DK02 leather swivel navigator seat
- Audio:
  - Fusion RA210 entertainment system
  - 2 Fusion interior loudspeakers, in the saloon
- 1 Adjustable reading light
- 1 230 V socket
- 1 dual USB port



## GALLEY - FORWARD

Headroom: 2,04 - 2,16m / 6'8" - 7'1"

- 2 part forward galley
- Corian Glacier White work surface with Alpi walnut moulded rails to starboard
- Alpi walnut work surface to port
- 2 Coachroof windows with pleated blinds including opening porthole with mosquito net
- LED strip light under upper lockers

To starboard:

- 1 1 rectangular stainless steel sink (550 x 362 x 204mm / 1'10" x 1'2" x 8")
- 1 Mixer tap with hot/cold water under pressure
- 1 ENO Bretagne 3-ring gas stove 19 L thermostatic oven with stainless steel grill mounted on gimbals - Protection bar - Stowage below the oven with drop-down door
- Miele 230 extractor hood
- 1 3 doors 1 shelf 3 drawers unit
- Large storage below the floor with space for 18 bottles
- 1 20 L bin + 2 x 16 L for recycling
- A storage area is provided in the starboard aft cockpit with 2 plastic trays for storing recyclable waste (size of 1 tray: 600 x 400 x 270 mm)
- Pillar with beige cover

to port:

- 24V 157L / 41 US Gal stainless steel fridge with front-opening door + 1 stainless steel built-in 75L / 20 US Gal fridge drawer compartment
- 1 75L / 20 US Gal deep freeze drawer (230V)
- Fitted lockers and closed shelving
- 1 3 drawers cabinet

## OWNER'S CABIN

Headroom: 2,08 - 1,91m / 6'10" - 6'3"

- Double bit (2,00 x 1,60 - 1,01 m/6'9" x 5'3" - 3'4") with Lounge Greige 160 fabric padded headboard, accessible from both sides. large stowage area under the bed + 1 drawer on port side.
- 2 Hanger closets with built-in LED lighting
- 2 Low units along the port side of the hull with large drawers
- 2 Flexible and adjustable LED reading lights on the headboard
- 2 230V Sockets
- 2 Double USB sockets on the headboard
- Indirect lighting below the bed and ceilings
- 4 Overhead lights
- 4 T44 flush-fit deck hatches with blind/mosquito nets
- 1 T10 deck hatch with blind/mosquito net
- 2 Portholes with rigid sliding blind

## PRIVATE HEAD - OWNER'S CABIN

To starboard

Headroom: 2,08m - 1,94m / 6'10" - 6'4"

- Separate shower with plexiglass door - Wooden seat - Wood shower tray
- Work top in Corian Glacier White
- 1 Integrated polyester basin - Mixer tap
- 1 Storage cabinet under washbasin
- 1 Large mirror
- 1 Tecma fresh water/seawater electric WC
- 1 64 L / 17 US Gal rigid holding tank
- Toilet accessories
- 1 T10 deck hatch with blind/mosquito net
- LED indirect lighting + 2 Overhead lights
- 1 230 V socket

## PORT AFT CABIN - VIP

Headroom: 1,96m / 6'6"

- 1 Double bed (2,00 x 1,55m / 6'7" x 5'1")
- 1 Hanging locker, 1 Cupboard with shelves, with incorporated LED lighting
- 1 Opened compartment along the side of the hull
- 1 Drawer under the bed
- 2 flexible and multi-directional reading lights at bedhead
- 1 dual USB port
- 1 230 V socket
- 1 Overhead light
- 1 Porthole with rigid sliding blind and indirect LED lighting
- 1 Opening window on coaming with pleated blind
- 1 Opening porthole beneath cockpit bench seat

## AFT PORT HEAD COMPARTMENT - VIP

Headroom: 2,02m / 6'8"

Accessed via port side aft cabin

- Separate shower - 1 mixer tap - White polyester shower tray
- Glacier White corian work top with sink and mixer tap
- 1 Bathroom cabinet - 2 doors with mirror
- 1 Manual toilet
- 1 64 L / 17 US Gal rigid holding tank
- Toilet accessories
- 1 Opening porthole on coaming in side window, opaque film, mosquito screen
- LED indirect lighting + 2 Overhead lights
- 1 230 V socket

## STARBOARD AFT CABIN

Headroom: 1,96m / 6'6"

- 1 Double bed (2,00 x 1,55m / 6'7" x 5'1")
- 1 Hanging locker (accommodates washer dryer option), with incorporated LED lighting
- 1 Opened compartment along the side of the hull
- 1 Drawer under the bed
- 2 flexible and multi-directional reading lights at bedhead
- 1 dual USB port
- 1 230 V socket
- 1 Overhead light
- 1 Porthole with rigid sliding blind and indirect LED lighting
- 1 Opening window on coaming with pleated blind
- 1 Opening porthole beneath cockpit bench seat

## AFT STARBOARD HEAD COMPARTMENT

Headroom: 2,02m / 6'8"

Access through saloon

- Separate shower - 1 mixer tap - White polyester shower tray
- Glacier White corian work top with sink and mixer tap
- 1 Bathroom cabinet - 2 doors with mirror
- 1 Manual toilet
- 1 64 L / 17 US Gal rigid holding tank
- Toilet accessories
- 1 Opening porthole on coaming in side window, opaque film, mosquito screen
- LED indirect lighting + 2 Overhead lights
- 1 230 V socket

**ENGINE**

- Engine Yanmar Diesel:
  - 150 HP, Propeller shaft, Common Rail
- Engine control at the starboard helm station - Control panel
- 24 V tunnel bow thruster - Side Power - 8,7 CV - Thrust 160 kg - Tunnel diameter 250 mm + 4 Dedicated batteries (50Ah - 12V)
- Engine compartment:
  - Soundproofing foam: 40mm / 1' 9/16"
  - Ventilation: 2 air inlets and 2 forced air outlets
  - LED lighting
- Engine data available on Yanmar screens at steering station and on Raymarine screen
- 1 Alternator (12V / 130Ah)
- 2 x 250 L/2 x 66 US Gal aluminium diesel tanks (under saloon flooring) - Electronic gauge - Low level alarm - 1 Deck filler for each tank (to port)
- Filters: Seawater - Diesel - Water separator
- 4 folding blades propeller
- 1 Engine access through companionway (opening with 2 gas struts)
- 2 Engine access through passageway and aft cabins, 1 Accessed via port side aft cabin

**PLUMBING**

- 4 Rotomoulded freshwater tanks 4 x 200L / 4 x 53 US Gal, under saloon floor, port and starboard - 2 Deck fillers to starboard (1 deck filler fills 2 tanks) - Crossover valves for the tanks below the floor in front of the companionway
- Pressurised electric water pump - Expansion tank - Inline filter
- 60 L / 16 US Gal Electric water heater (powered by the engine or shore power socket)
- 64 L/17 US Gal black water holding tank for each WC with electrical gauge
- Automatic shower draining pumps
- 2 Electric bilge pumps
- 1 Manual bilge pump
- 1 Shore fresh water supply

**GAS**

- 1 Box for 2 gas bottles in the anchor locker (Diameter: 0,28m / 11" x Height: 0,45m / 1'6")
- Regulator and safety tap
- Gas leak detector

**SMART BOARD**

"SEANAPPS" smart technology:

- For monitoring the boat's status and receiving alerts as well as maintenance advice via the associated mobile application.
- The type of information collected (GPS position, batteries, engine info, navigation data, etc.) varies according to the boat's configuration.

CONNECT YOUR BOAT FREE YOUR MIND

**ELECTRICITY**

- 24 electrical panel on chart table + Navicolor 3.5 screen (Breaker, Voltmeter, Water gauge, Fuel gauge, Battery warning, Fuel warning, Water warning) + Single USB socket
- Wireless radio controlled switches (no battery) for the lighting
- 10" touchscreen on port bulkhead at bottom of companionway, dedicated to Ship Control, used to control all functions from the saloon
- **Ship Control technology** control numerous functions from the navigation screens (or from a tablet or smartphone using a dedicated app):
  - Anchoring and masthead navigation lights
  - Lighting of boom, spreaders (optional), underwater spotlights (optional)
  - Courtesy light in cockpit
  - Direct lighting
  - Deck searchlight
  - Inverter
  - Fridge
  - Water unit
  - Bilge pumps
  - Air conditioning (Option)
  - Generator (Option)
  - Audio
  - Monitoring of tanks
  - Battery monitoring
- 24V circuit
- 8 AGM service batteries (140Ah)
- 1 AGM engine battery (50Ah)
- 1 Alternator 24 V (85Ah)
- Battery cut-off switch easily accessible under the port aft cabin access step
- 1 Battery charger (24V - 100Ah)
- 1 Power distributor
- 13 230V Sockets:
  - 2 in the forward cabin
  - 1 in the heads
  - 1 in the aft cabins
  - 1 in the saloon (Port)
  - 1 at chart table
  - 4 in galley
  - 1 in the engine compartment
  - 1 in the sail locker
- 6 Dual USB socket:
  - 2 in the forward cabin
  - 1 in the aft cabins
  - 1 on the electrical panel
  - 1 at chart table
- 1 Shore power socket 230 V, next to the port side helm station
- LED lighting:
  - Overhead lights, with dimmer
  - Reading lights
  - Indirect lighting, with dimmer
  - Side decks courtesy lighting
- LED navigation lights:
  - 1 Masthead light
  - 1 Steaming light
  - 1 Anchor light on masthead
- Deck searchlight (Halogen)
- Wire runs for option cables

**MISCELLANEOUS ITEMS**

Smoke detector



**RIGGING PACKS (Compatible with the 2 masts)**

|  | DOWNWIND | UPWIND | DOWNWIND + UPWIND |
|--|----------|--------|-------------------|
| <ul style="list-style-type: none"> <li>German System:               <ul style="list-style-type: none"> <li>- 1 Dyneema core two-way mainsail sheet at the helm station (12mm diameter - length 62 m)</li> <li>- 1 Additional double jammer for the starboard halyards)</li> <li>- 2 Additional Harken E80 blocks on the boom</li> </ul> </li> </ul>  | ■        | ■      | ■                 |
| <ul style="list-style-type: none"> <li>2 Electric genoa winches (H70.2STA EH - 24V) + 1 Winch handle</li> </ul>  | ■        | ■      | ■                 |
| <ul style="list-style-type: none"> <li>Asymmetrical spinnaker rigging / Code 0:               <ul style="list-style-type: none"> <li>- 4 Harken simple blocks,</li> <li>- 1 Wichard single pulley,</li> <li>- 2 Additional jammers,</li> <li>- 2 Sheets diameter 14 mm, length 40 m,</li> <li>- 1 Asymmetric spinnaker tack diameter 12 mm, length 5 m,</li> <li>- 1 Code 0 halyard diameter 12 mm, length 88 m</li> </ul> </li> </ul> | ■        |        | ■                 |
| <ul style="list-style-type: none"> <li>Dacron genoa on furler</li> </ul>   |          | ■      | ■                 |
| <ul style="list-style-type: none"> <li>Genoa sheet track on the coachroof + Genoa sheets (the self-tacking jib track and the traveller are retained)</li> </ul>  |          | ■      | ■                 |

**STAYSAIL RIGGING PACK (Compatible with the 2 masts)**

- 2 Harken Element E80 blocks, including 1 with becket
- 1 Clutch to starboard
- 1 Double Wichard forestay sail bolt plate on forward deck with removable forestay
- 1 Dyneema halyard sheave with block for staysail
- Punch core sheet (12mm diameter - 45m)
- the self-tacking jib track and the traveller are retained

**MOORING PACK**

- Delta 40 kg/88 lbs anchor (galvanized steel) (stainless steel anchor upgrade as an option)
- Chain (Diameter: 12mm / 1/2" - Length: 70m / 230')
- Ropes (Diameter: 22mm / 7/8" - Length: 50m / 164')
- 10 Fenders:
  - 4 XL (Diameter: 300mm / 12" - Length: 1 130mm / 3'8")
  - 6 L (Diameter: 300mm / 12" - Length: 880mm / 2'11")
- 4 Moorings lines (Diameter: 18mm / 11/16" - Length: 15m / 49'3")
- Anchor positioner

**MOORING PACK (inflatable)**

- Delta 40 kg/88 lbs anchor (galvanized steel)
- Chain (Diameter: 12mm / 1/2" - Length: 70m / 230')
- Ropes (Diameter: 22mm / 7/8" - Length: 50m / 164')
- 8 Inflatable fenders (Diameter: 360mm / 1'2" - Length: 1 200mm / 3'11")
- 4 Moorings lines (Diameter: 18mm / 11/16" - Length: 15m / 49'3")
- Anchor positioner



## OPTIONS

### NAVIGATION ELECTRONICS: RAYMARINE

- Chart table: AXIOM Pro 12" multi-function touchscreen
- Quantum Doppler 2 radar
- AR ClearCruise (augmented reality)

### RIGGING - SAILS

- Hydraulic backstay (for classical mast)
- Black lacquered mast with in-mast furling
- White lacquered mast with in-mast furling
- Black lacquered classical mast, manual hydraulic backstay piston, black lacquered canoe boom
- Furler/Boom V-shaped boom furler, black lacquer for classical mast
- Hydranet mainsail
- Hydranet self-tacking jib (replacing Dacron, standard)
- Genoa Hydranet (implies rigging pack)
- Code 0 with "Top Down" furling system
- Electric Genoa sheet furler on deck

### WINCHES

- Upgrade 2 electric rewind coach roof winches Harken H60.2 STAEH

### OUTSIDE PROTECTIONS

- Coachroof sprayhood, Lexan rigid glazing, Charcoal Grey
- Sunshade on foredeck, Charcoal Grey
- Cockpit bimini with LED lighting, Charcoal Grey
- Semi rigid Bimini cockpit top with LED lighting, Charcoal Grey central sliding canvas panel for manual opening
- Full closure of the bimini (2 sides + aft), Charcoal Grey
- Full closure of the rigid bimini (2 sides + aft), Charcoal Grey

### MOORING LINES - MOORING

- Stainless steel upgrade to replace the galvanized anchor in the mooring packs
- 8 NOMEN galvanized aluminum retractable cleats (in lieu of standard)
- Retractable capstan (Bow)

### HULL - DECK - COCKPIT

- Integrated hydraulic gangway, on port
- Tender launching system (folding ramp with roller for recovering the aft platform, 1 manual winch) + Electrical inflater + Fresh water inlet fed by the tanks for rinsing the tender
- Outboard engine bracket
- Black composite Y-shaped steering wheels
- White composite steering wheels - 5 spokes
- Caron Y-shaped steering wheel
- Composite flagstaff 1,20 m/3'11"
- Metallic hull paint (Hull - Aft transom - Bowsprit)
- Williams 280 Minijet Tender - 80 HP
- Slatted teak catwalks
- Teak slatted roof

### INTERIOR WATER SYSTEM

- Seawater electric pump, in galley
- Watermaker (100 l/h / 26 US Gal/h - 24/230V)

## BURNERS

- 4 Underwater searchlights (2 stern, 2 bow)
- LED spreader bar lighting for standard anodised mast with in-mast furling
- LED spreader bar lighting for black lacquered mast with in-mast furling
- LED spreader bar lighting for white lacquered mast with in-mast furling
- LED spreader bar lighting for black lacquered classical mast

## COCKPIT COMFORT

- Removable cockpit gas grill
- Cockpit cool box below port side helm seat 30 L/8 US Gal

## INTERIOR EQUIPMENT

### LAYOUT VERSIONS

- 3 cabins 3 heads version
- Skipper cabin replacing the sail locker of the foredeck:
  - Headroom: 1,85m / 6'1"
  - Access through T70 deck hatch,
  - Stainless steel ladder,
  - 1 Bed (1,92m x 0,65m - 0,58m) / 6'4" x 2'2" - 1'11") Foam mattress
  - PVC cover, Marlin Weiss
  - Stowage,
  - 1 dual USB port,
  - 1 230 V socket,
  - 1 Overhead light,
  - 1 Head separate from cabin with WC, washbasin, shower

### AMBIANCE

- Interior woodwork: Alpi oak 3 gloss + Alpi oak floorings
- Interior upholstery according to colour chart: Fabrics, Leather, Nubuck, Ultraleather

### MULTIMEDIA

- TV pre-assembly on lifting system, in the saloon (recommended TV size: 46")
- TV pre-assembly, in the forward cabin (on forward bulkhead)
- Hifi: FUSION Apollo RA670 amp with B&W subwoofer + speakers in master cabin

### DOMESTIC APPLIANCES

- Dishwasher for 9 sets (230V)
- Wine cellar 19 bottles (230V)
- Built-in 22 L grill and microwave combined oven (230V)
- Washer dryer: 8 kg for washing, 5 for dring (230V)
- 75 L deep freeze compartment with built-in 230 V ice maker + dedicated 500 W inverter (replacing standard 75L / 12-24 deep freeze drawer)

### ON BOARD COMFORT EQUIPMENT

- Safe, in the forward cabin
- Spring mattress in the owner's cabin (thickness: 180mm / 7")
- Spring mattress in the aft cabins (thickness: 160mm / 6")
- Charcoal Grey lee cloth, in the starboard aft cabin
- 3 Lithium batteries to replace the AGM batteries - Weight saving: Approximately 170 kg / 375 lbs  
*The lithium batteries can be used in exactly the same way as the greater number of AGM batteries that they replace. This technology allows 100% of the battery capacity to be used compared with 75% for the AGM batteries. The engine battery is still AGM.*
- Electric battery switch (connected to the Ship Control, controls powering on or shut-off of batteries remotely)

### SERVICE

- Commissioning (Canet or Les Sables d'Olonne)
- Premium Handover